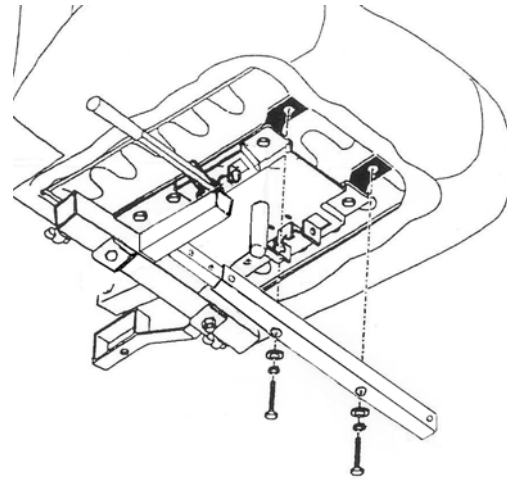
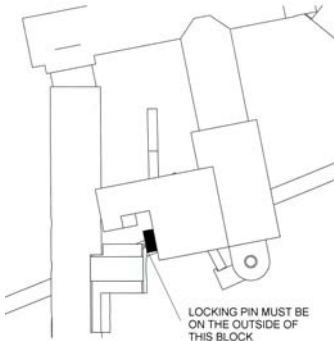

**FIG. 1**

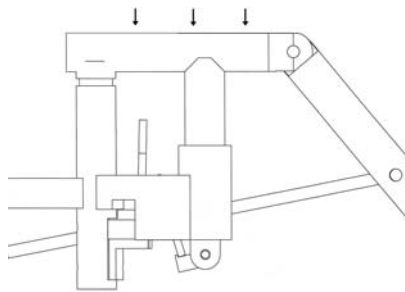

**FIG. 2**

## ELR INSTALLATION



**FIG. 3**



**FIG. 4**

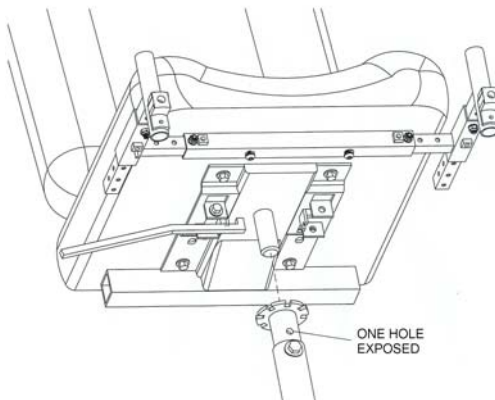

**FIG. 5**

1. Before installing the main support tube to the seat, place the bolts in the adjustable components at locations desired (Fig. 1). Securely tighten the four locations.
2. Depending on the seat, refer to Fig.1 or Fig.2 for the mounting location of the assembly. Securely tighten to the base of the seat.
3. Place the footrest into the top of the round tube. It will be on an angle and the locking pin **must** be on the outside of the receiving block, as shown in Fig. 3.
4. Apply firm downward pressure, this will cause the locking pin to be pushed in and align the two blocks. Keep the downward pressure until the footrest is locked. (It may help to pivot the footrest, slightly side to side, while applying the pressure.)
5. To prevent scratching of the shroud, the seat post **must** be set to a minimum height. The lowest post setting should have one adjustment hole exposed (FIG. 5).