

LIFT FRAME REMOVAL

Always unplug chair from outlet first!

If possible, flip chair upside down on a saw horse, this will make it easier for lift frame removal.

- 1) After having chair upside down, there will be 4 or 8 7/16 x 2-1/2" lag screws mounting lift frame to the bottom of the arms of the lift chair. Remove lag screws by turning counter clockwise.
- 2) Open the footrest you will see 3 clevis pins, remove the clevis pin connecting the top piece to the recline bar.
- 3) Cut Ty Wraps holding handwand cord to lift frame and unplug cord from motor assembly. Pull handwand cord free and clear of lift frame.
- 4) Lift out lift frame by grabbing both lower base and top piece at the same time. This will prevent lift frame from opening when lifting.

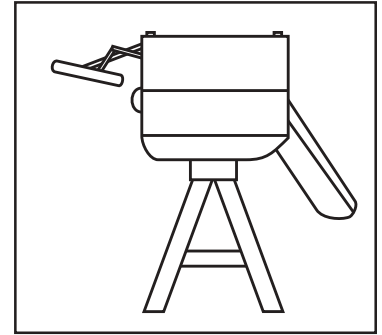

Step 1

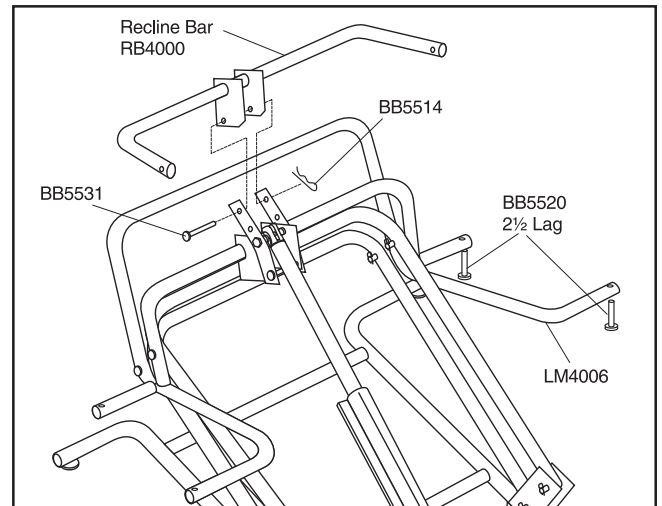

Step 2

TO REINSTALL LIFT FRAME INSTALLATION OF LIFT FRAME

- 1) Having chair upside down grab lift frame by lower base and top piece and place the lift frame into lift chair motor side down and gear casing towards the back of lift chair. DO NOT Bolt the Lift Frame Down YET!
- 2) Go to the front of the chair and open the footrest about 10" to 12 inches, install clevis pin with washers and spacers into recline bar and lift frame recline bar brackets. See diagram.
- 3) Once clevis pin and hair pins are in place, close foot board. The lift frame should go back to its original position to align the holes in lift frame to the holes in wood frame. Insert nylon washers between the metal lift frame and wood arm of chair, bolt the lift frame down using 2-1/2" lag bolts.
- 4) Place chair back over upright, test chair for ride.

Any Questions contact: Golden Technologies 1-800-624-6374

Procedures for the removal and replacement of all styles of supersagless scissor mechanisms and recline bars on all models of the 4000 series frames.

SECTION I REMOVAL OF SEAT MECHANISMS

- Step 1. Operate the chair into the fully reclined position if possible.
DISCONNECT THE POWER CORD FROM ELECTRICAL OUTLET
- Step 2. Remove the four hexhead bolts which connect the back cushion to the scissors mech's. 2 on each side of the lower outer back.
- Step 3. Remove the hexhead bolt located at the rear of each of the two scissor mechanisms.
- Step 4. Tip the chair onto it's back so that the footboard is pointing up.
USE CAUTION TO PROTECT YOUR FLOOR FROM THE NOW EXPOSED MECH'S
- Step 5. There will be three clevis pins at the front center of the metal lift frame. The top pin is for the recline.
Remove the clevis pin which connects the recline bar to the metal frame.
- Step 6. Remove the hexhead bolt located at the front of each scissor mech.
- Step 7. **USE EXTREME CAUTION TO PROTECT THE INSIDE OF THE CHAIR ARMS DURING THIS STEP. IF POSSIBLE, PLACE A SHEET OF CARDBOARD BETWEEN THE SEAT AND THE INNER ARMS ON EACH SIDE.**
- Step 8. Remove 2 lag bolts 1 1/4 x 7/16 located aprox. middle of scissor mechanism each side of arm.

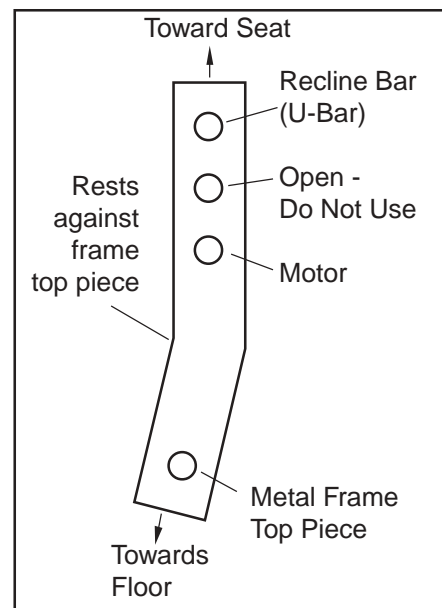

Diagram for step 5

NOTE: For Repairing **Capri** chair, steps are similar. Omit Step 2 and Step 6.

FOR THE REMOVAL OF RECLINE BAR FOLLOW **SECTION II A&B**
FOR THE REMOVAL OF SCISSOR MECHANISMS FOLLOW **SECTION III A& B**

SECTION II A REMOVING THE RECLINE BAR

- Step 1. There are 2 bolts remaining 1 at each side of recline bar.
Position the seat upside down with the recline bar exposed.
- Step 2. Using a 7/16" wrench * (a 1/2" wrench may be necessary on some larger models)* hold the lock nut on either side of recline bar while using the *7/16"* wrench or socket to remove the recline bar bolt from the outside of the seat.
- Step 3. Repeat step 2 on the other side of the recline bar.

SECTION II B REPLACING RECLINE BAR

- Step 1. Insert recline bar bolt until the end of the bolt appears on the inside of the seat.
Step 2. Place a nylon washer on the end of the bolt.

Lay the replacement recline bar into the seat in the same position as the old one.

- Step 3. Align the holes in either end of the recline bar with the bolt and tighten the bolt firmly.
Step 4. Place a, 1/4" i.d.x3/4"o.d.x1/8" (item #) thick, nylon washer on the end of the bolt followed by a 1/4" flat metal washer (item #) and then the 1/4" locknut (item #).
Step 5. While holding the head of the bolt, tighten the locknut until the recline bar is held firmly without binding. The recline bar should move up and down smoothly without the locknut moving in either direction.

Temporarily secure the front of the recline bar to the bottom of the seat.

SECTION III A
REMOVING THE SCISSOR MECH'S

Continuing from Section I step 8.

- Step 1. Remove the front two hexhead bolts from the side of each mech.
- Step 2. Remove the screws which attach the footboard to the scissor mech's.

SECTION III B
REPLACING THE SCISSOR MECH'S

Check to ensure that the left and right mech's are on their appropriate sides. The footboard brackets should bend in toward the center of the chair.

- Step 1. Place the left mech along the left side of the seat. Align the two wizloc bolts with the two front and back holes of seat and mechanism, insert and tighten.
- Step 2. Replace the screws in the footboard using the same holes from the original set of mech's.
- Step 3. Repeat steps 1 & 2 on the right side.

SECTION IV
REPLACING THE SEAT ASSEMBLY INTO THE BASE

REMEMBER TO USE CAUTION TO PROTECT THE INNER ARM AREA DURING THIS STEP

For vinyl chairs it is necessary to be extra careful to prevent seat and scissor mechs from damaging the inside arms of arm assembly.

We advise using a piece of cardboard to be placed in-between arm & scissor mech after mechs are unbolted from arms of chair. This will help prevent unnecessary damage to inside arms of chair when removing seat assembly.

- Step 1. Position the seat, face up, while holding the seat on each side, lower the seat into the arms. Push outward, lightly, on each side as lower the seat in.
- Step 2. Reattach the back portion of each mech using the original bolts. Do not tighten these bolts completely at this point.
- Step 3. Lift the bottom of the footboard in order to place the chair in the recline position.
- Step 4. Align the bottom holes on each side of the back assembly and insert the original bolts. Do not tighten these bolts completely at this point.
- Step 5. Raise the back assembly up in order to align the top holes and insert the original bolts. Tighten all four bolts now.
- Step 6. With the chair still in the recline position, align the front of the mech's and insert the original bolts. Turn in, but do not tighten these bolts at this point.
- Step 7. Pull the front of the seat forward in order to position the mech's evenly on each side. Tighten all four bolts now.
- Step 8. Tip the chair onto it's back to allow easier access to the recline bar.
- Step 9. Plug in the power cord and operate the chair either up or down until the front brackets in the recline bar and the top holes in the motor bracket are lined up.
- Step 10. Insert the original 2-1/2" clevis pin through the motor bracket on either side. Place a nylon washer on the clevis pin between the motor bracket and the top of the motor shaft. Repeat this procedure on the other side of the shaft. Insert the hairpin into the end of the clevis pin.
- Step 11. **DOUBLE CHECK ALL BOLTS TO ENSURE THAT THEY ARE TIGHT!! THE CHAIR SHOULD OPERATE PROPERLY NOW.**