

ASI BRAKE REPLACEMENT INSTRUCTIONS

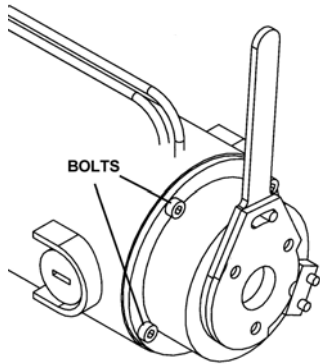

FIG. 1

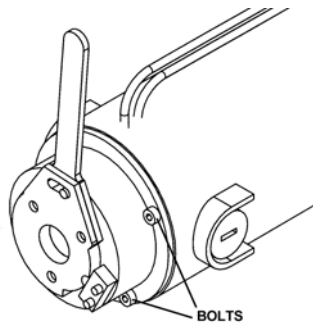

FIG. 2

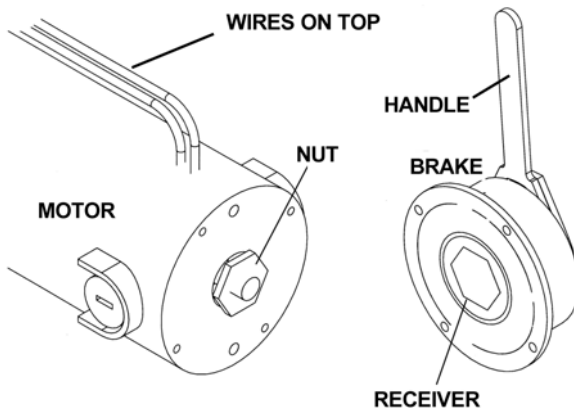

FIG. 3

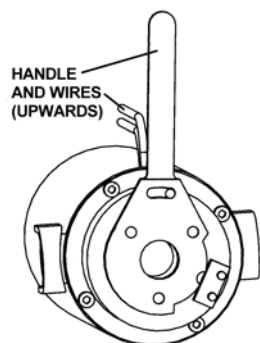

FIG. 4

Removal and Installation

BE SURE THE BATTERIES ARE DISCONNECTED BEFORE ATTEMPTING ANY REPAIR OR REPLACEMENT!

1. Remove the four bolts shown in figures 1 and 2. Then pull the brake off of the motor.
2. Align the new brake receiver with the nut on the motor. The handle must be pointing in the same direction as the motor wires. See figure 3.
3. Use a thread locker such as Loctite on the (4) bolts and firmly tighten them into the motor housing. (FIG.1 and FIG. 2)

Be sure the brake handle and the motor wires are pointing in the same direction. (FIG. 4)